



WALL MOUNTING CABINETS

SUBMITTAL DATA

PROJECT

Job Name: _____ Submitted by: _____ Date: _____

Location: _____ Approved by: _____ Date: _____

Engineer: _____ Order No.: _____ Date: _____

Contractor: _____ Notes: _____

Sales Rep.: _____

DESCRIPTION

Calefactio's wall mounting cabinets offer an adjustable depth (range of 1½ in or 40 mm) and are designed to hold distribution manifolds in walls of between 4 and 6 in depth. Priorise Caltherm manifolds to facilitate wiring and adjustments. These cabinets allow an easy access to the distribution manifold through a door that can be secured with the provided safety lock to protect the manifold while offering a clean look. The door, frame and housing are in 18 gage steel and covered with a white baked paint.

Model#	Height		Width		Depth	Weight	
	in	mm	in	mm		lb	kg
MWC24	25¼	640	24	600	4¾ to 6 in 110 to 150 mm	23.4	10.6
MWC32	25¼	640	32	800		30.0	13.6
MWC40	25¼	640	40	1000		35.3	16.0
MWC52SS*	25¼	640	52	1320		43.4	19.7

* Door and frame in 18 gage stainless steel (SS304).

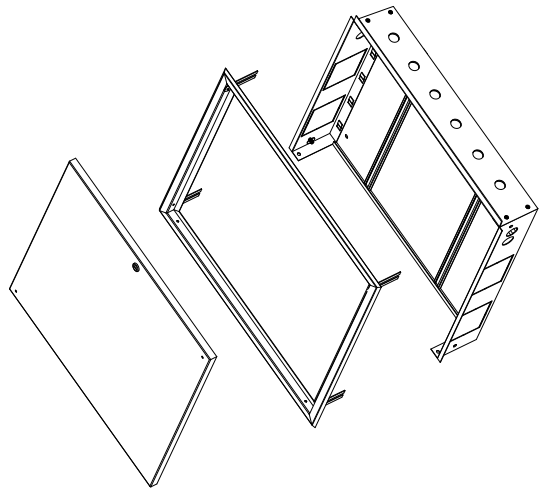

TYPICAL SPECIFICATION

Furnish and install as shown on plans and described as follows Calefactio's wall mounting cabinet measuring _____ in (_____ mm) length, 25¼ in (640 mm) height and offering an adjustable depth ranging from 4¾ in (110 mm) to 6 in (150 mm). The cabinet must offer the possibility to be installed in 4 to 6 inches depth walls, have a door equipped with a lock, be made of 18 gage steel (SS304 stainless steel for model #WMC52SS). The door, frame and housing must be covered with a white baked paint. The cabinet must be Calefactio's model WMC _____ or approved equivalent.

Quebec, Canada
T (450) 951-0818
F (450) 951-2165

CALEFACTIO RADIANT.COM